

Thank you for purchasing the KRG X-Ray Tool-less LOP Kit. We hope that you enjoy this accessory and we think that you'll find it to be high quality and an exceptional value.



INST-TLP-XRY

X-Ray Tool-less LOP Kit

for Gen 4 Chassis Only

Contents of Package:

- 1ea LOP Seal
- 4ea Spring Pin
- 1ea LOP Beam
- 1ea Thumbwheel
- 1ea M5 x 25mm Button Head Screw
- 1ea LOP Lock Bezel
- 1ea LOP Lock (with M5 x 40mm Button Head Screw installed)
- 1ea Spring (.484 x .500)
- 1ea Washer (.203 x .625)
- 1ea Tri-lobe Thumbscrew

Installation Instructions:



Safety Warning: Before you attempt any installation, make sure your rifle is unloaded. Also, before starting remove the bolt and magazine from the rifle.

Part I: Remove buttpad mounting assembly

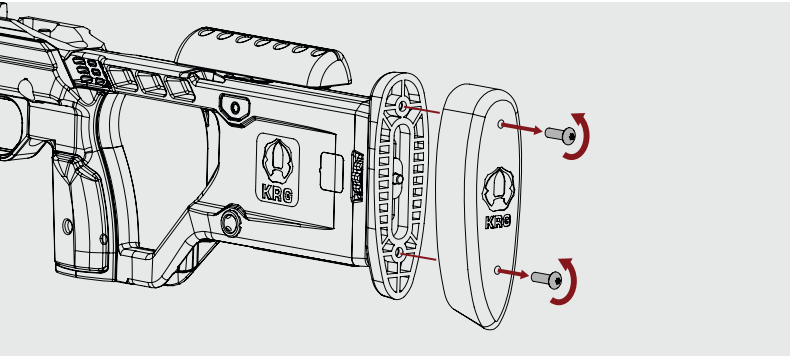

Step 1: Remove the buttpad using a 3mm metric hex/allen wrench. Set aside the buttpad and screws. You will need them for the reassembly (Part 2, step 6).

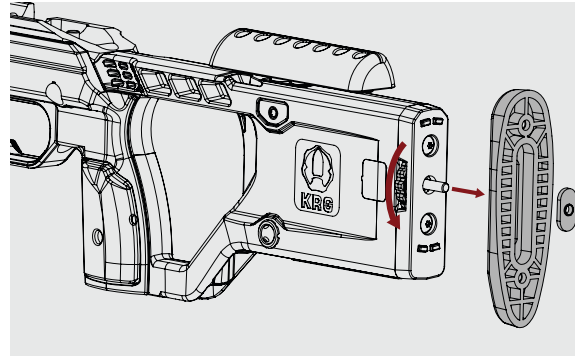

Step 2: Fully unscrew the thumbwheel then remove the weld nut and buttpad mount plate. Set aside the buttpad mount plate and the weld nut. You will need them for the reassembly (Part 2, step 5).

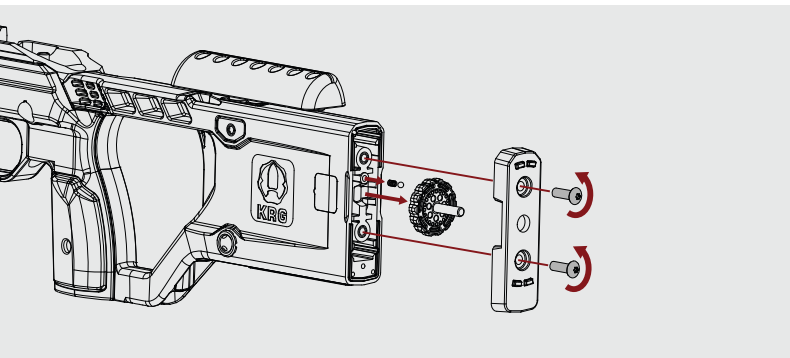

Step 3: Remove pad base from X-Ray stock. Carefully take out the thumbwheel with ball bearing and spring detent inside. You will not need these items for tool-less LOP reassembly, but save these parts if you need to return to the original assembly later.

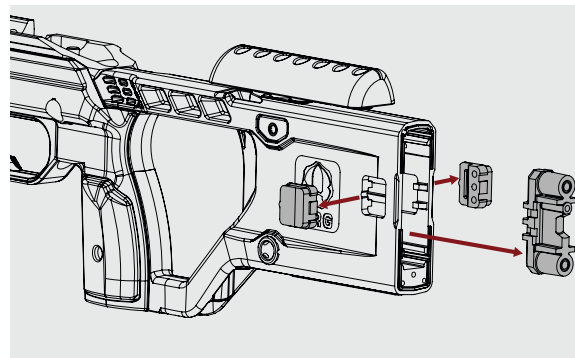

Step 4: Push rear insert mount inside and the LOP lock plugs will come loose. Remove the LOP lock plugs and the rear insert mount. You will not need these items for tool-less LOP reassembly, but save these parts if you need to return to the original assembly later.

Part II: Install Tool-less LOP assembly

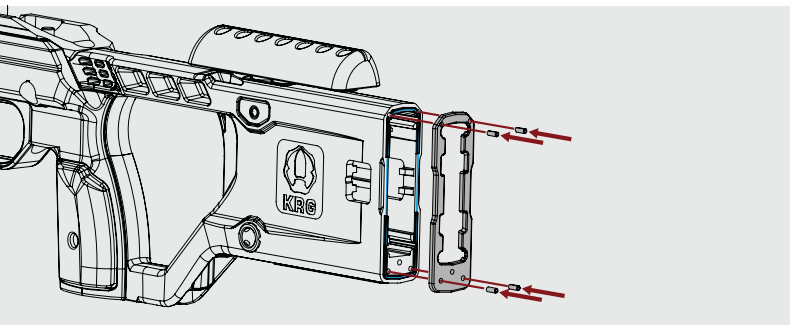

Step 1: Place LOP seal into position and use a light hammer to secure it in place with 4 spring pins.

Note: Light to medium adhesive can be applied to glue on the rear cover plate. This is not required.

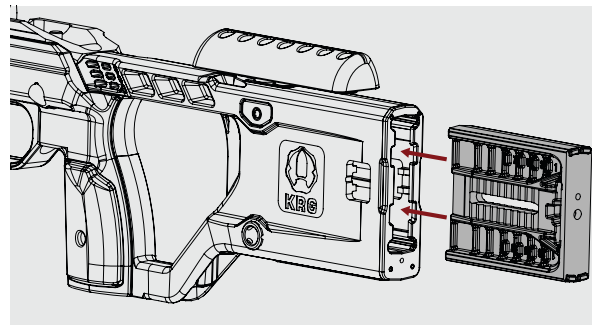

Step 2: Insert LOP beam into the buttstock.

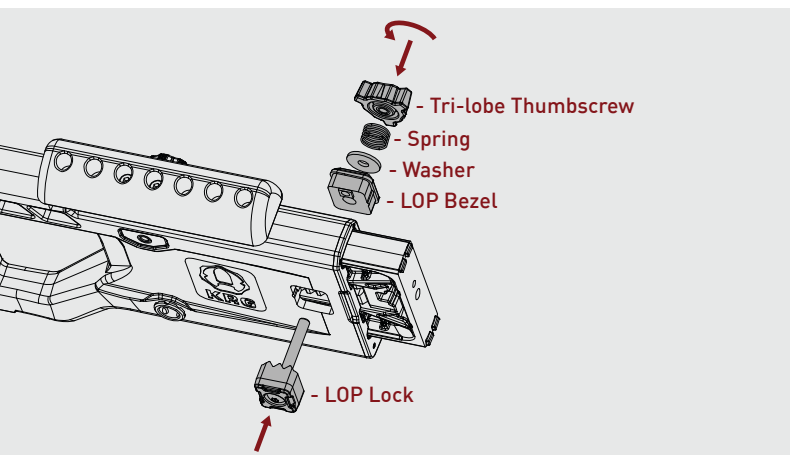

Step 3: Insert LOP bezel on the right or left side of the of the buttstock based on your preference. Insert LOP lock screw on the other side. Install washer, spring and screw on the tri-lobe thumbscrew.

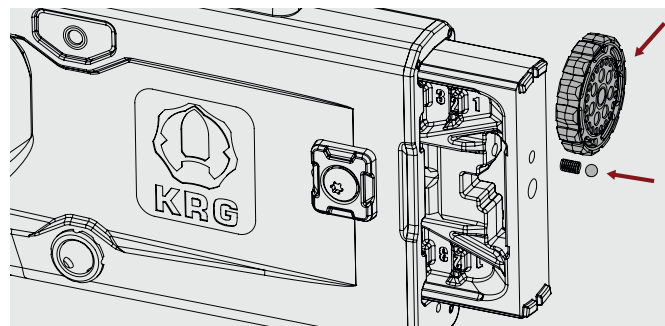

Step 4: Insert the thumbwheel.

Note: Ball bearing and spring detent is optional, would need to be put in place before thumbwheel is inserted.

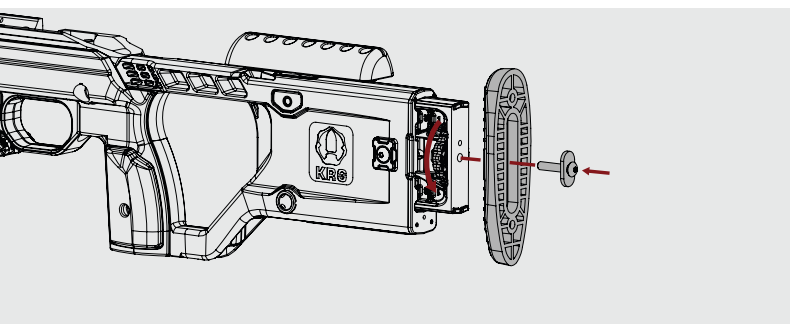

Step 5: Fully thread through and tighten M5X25mm button head screw into M5 flat weld nut. Install buttpad mount plate onto the LOP beam with weld nut/button head screw assembly and tighten in place by turning thumbwheel screw clockwise.

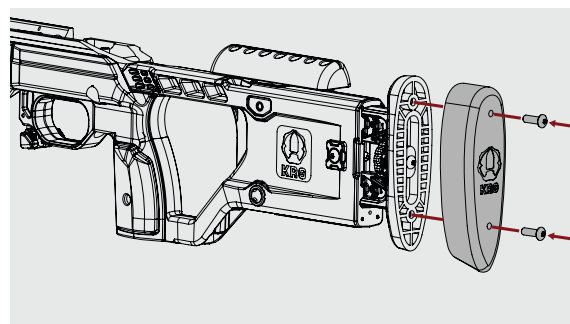

Step 6: Reinstall the buttpad.

Length of Pull (LOP) Adjustment

Tool-less LOP adjustment:

Now the tool-less LOP assembly is fully installed. In order to adjust the length of pull, simply loosen the tri-lobe thumbscrew by rotating counter-clockwise, move buttpad assembly in or out and retighten thumbscrew clockwise.