

Thank you for purchasing the KRG Bravo Chassis (Gen 2). We trust that you will enjoy your chassis and we think that you'll find it to be high quality and an exceptional value.



Bravo Chassis (Gen 2)

Contents of Package:

- Bravo Chassis
 - accepts AICS magazines (with or without spacer for T3 version), factory magazines for T1x, CZ-457
- Remington 700 SA/LA:
 - 1ea 1/4-28 x 1 3/4 Socket Head Screw (Rear Action Screw)
 - 1ea M6 Washer for Rear Action Screw
 - 1ea KRG L2 Rail Kit
 - 1ea 1-3 LOP Spacer Set
- Tikka T3, T1x, Howa 1500 SA:
 - 1ea M6 x 45mm Socket Head Screw (Rear Action Screw)
 - 1ea M6 Washer for Rear Action Screw
 - 1ea KRG L2 Rail Kit
 - 1ea 1-3 LOP Spacer Set
- CZ-457
 - 1ea M5 x 45mm Socket Head Screw (Rear Action Screw)
 - 1ea M5 x 18mm Socket Head Screw (Front Action Screw)
 - 1ea Bushing (for Front Action Screw)
 - 2ea M5 Washer (1ea for Rear/Front Action Screw)
 - 1ea KRG L2 Rail Kit
 - 1ea 1-3 LOP Spacer Set
- 1ea Mag Spacer (Rem 700 LA ONLY)

Installation Instructions:



Safety Warning: Before you attempt any installation, make sure your rifle is unloaded. Also, before starting remove the bolt and magazine from the rifle.

Part I: Remove action from existing chassis/stock

Step 1: Loosen the two screws that hold the action into the stock. Next pull the barreled action out of the stock. Remove the metal magazine spring plate from the trigger if you have a T3 and re-install trigger. For Remington you will need to remove the box magazine parts.

Note: The front action screw on Bravo Chassis is already in place, you will need to remove the o-ring retainer that holds it.

For Tikka T3
remove spring clip

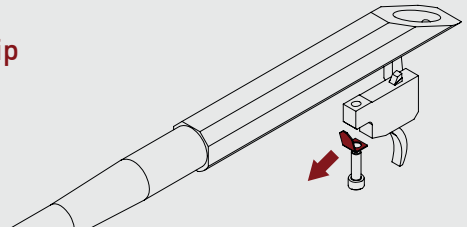

Part II: Install your action into the Bravo Chassis

Step 1: Insert the barrelled action into the backbone, tighten the front action screw to finger tight. Front action screw is in place already and captured by forend.

Step 2: With the whole assembly upside down, drop the rear action screw with washer into the hole just behind the trigger guard, turn the screw to engage the threads in the action. Again do not fully tighten.

Step 2a: for CZ-457 ONLY (Front Action Screw)

Clearance cut on bushing goes toward rear to clear magazine well screw

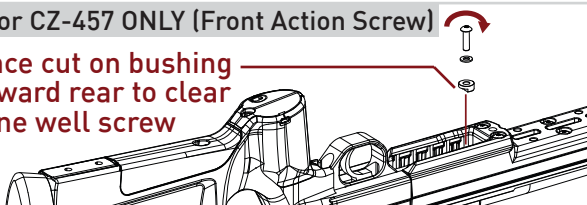

Insert the rear action screw

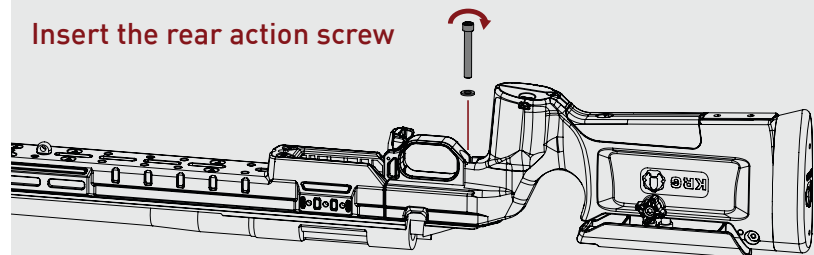

*** Front action screw already captured

Step 3: Pull the action towards the rear of the stock while holding the stock stationary. This is to seat the action against the recoil lug. A good way is to set the rifle vertical on the butt pad and bounce it on the ground a couple times.

Step 4: Making sure the action is level and not canted to the left or right in the chassis, begin tightening the actions screws starting with the front screw, tightening a little and then moving to the back screw and tightening a little. Keep switching back and forth to ensure even tension until the screws are fully tightened.

Step 5: Torque both screws to **65 in-lbs** of torque in an incremental manner, moving back and forth between the two screws until full torque is reached. *****for CZ-457 ONLY apply 45 in-lbs of torque to each action screw.**

Step 6: Insert a magazine to test for fit, the forend can be moved forward or backward a small amount to adjust the magazine fit. Additionally, the trigger guard can be moved a small amount as well if necessary, this will require removal of the barreled action. Due to the magazine design of the AICS magazine and the magwell of the Bravo, it may be possible to put pressure on the mag and push it up against the bolt. For this reason we do not recommend resting the gun on the magazine when firing. *****Ignore this step for T1x and CZ-457.**

Time to adjust the stock to fit you!

Length of Pull (LOP) Adjustment

Step 1: Remove the buttpad using a 3mm metric hex/allen wrench.

Step 2: Push the installed M5 buttpad mount screws out of the buttpad. Replace these screws with the longer screws, which are long enough to go through your desired amount of spacers. Insert desired quantity of spacers onto the longer screws

Step 3: Install the buttpad back onto the buttpad stock with the spacers captured between them.

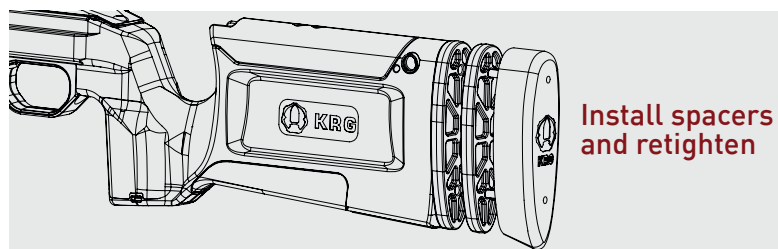
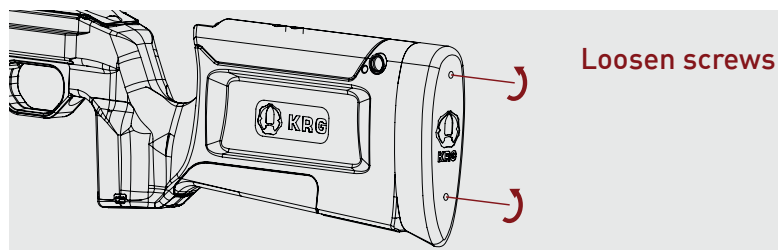

Cheek Height Adjustment

Step 1: Loosen the thumbscrew and move the cheekpiece to your desired position. Retighten the thumbscrew.

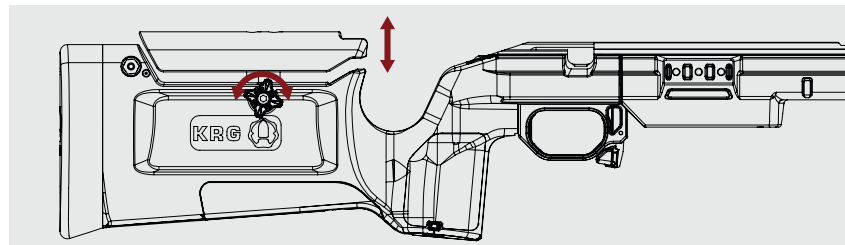

Mounting Options Data

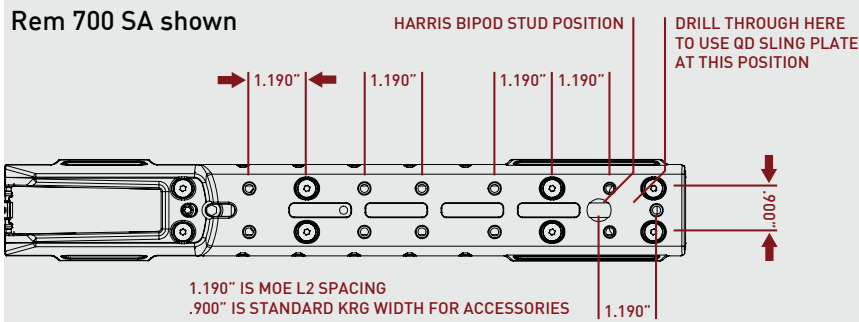
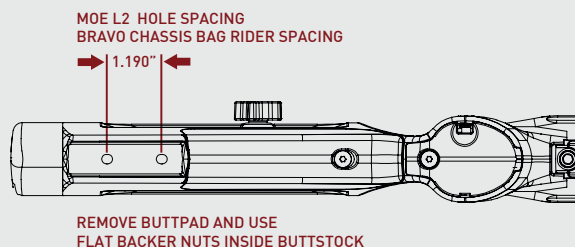

Recommended torque specs:

- Forend to Backbone – M5 fasteners – 20 in-lbs max (blue loctite recommended)
- ARCA Rail Mounting – M5 fasteners threading into Backbone – 20 in-lbs max (blue loctite recommended)
- Spigot Mount – M4 fasteners – 15 in-lbs
- NV Mount – M4 fasteners – 15 in-lbs

Tools required:

- 2.5mm, 3mm, 4mm, 5mm
- 3/16" (Rem 700 Action Screw) hex wrenches