

Thank you for purchasing KRG Bravo Chassis (Gen 2). We trust that you will enjoy your chassis and we think that you'll find it to be high quality and an exceptional value.



Bravo Chassis (Gen 2)

Contents of Package:

- Bravo Chassis partially assembled – accepts AICS magazines (with or without spacer for T3 version), factory magazines for T1x
 - Remington 700 SA/LA:
 - 1ea 1/4-28 x 1 3/4 Socket Head Screw (Rear Action Screw)
 - 1ea M6 Washer for Rear Action Screw
 - 1ea KRG L2 Rail Kit
 - 1ea 1-3 LOP Spacer Set
 - 1ea Mag Spacer (Rem 700 LA ONLY)
 - Tikka T3, T1x*, Howa 1500 SA:
 - 1ea M6 x 45mm Socket Head Screw (Rear Action Screw)
 - 1ea M6 Washer for Rear Action Screw
 - 1ea KRG L2 Rail Kit
 - 1ea 1-3 LOP Spacer Set
 - CZ-457 (factory magazine only):
 - 1ea M5 x 45mm Socket Head Screw (Rear Action Screw)
 - 1ea M5 x 18mm Socket Head Screw (Front Action Screw)
 - 1ea Bushing (for Front Action Screw)
 - 2ea M5 Washer (1ea for Rear/Front Action Screw)
 - 1ea KRG L2 Rail Kit
 - 1ea 1-3 LOP Spacer Set
- *factory magazine only

Installation Instructions:



Safety Warning: Before you attempt any installation, make sure your rifle is unloaded. Also, before starting remove the bolt and magazine from the rifle.

Part I: Remove action from existing chassis/stock

Step 1: Loosen the two screws that hold the action into the stock. Next pull the barreled action out of the stock. Remove the metal magazine spring plate from the trigger if you have a T3 and re-install trigger. For Remington you will need to remove the box magazine parts.

Note: The front action screw on Bravo Chassis is already in place, you will need to remove the o-ring retainer that holds it.

For Tikka T3
remove spring clip

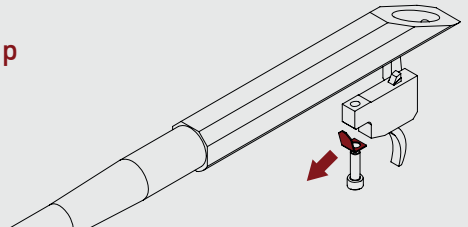

Part II: Install your action into the Bravo Chassis

Step 1: Insert the barrelled action into the backbone, tighten the front action screw to finger tight. Front action screw is in place already and captured by forend.

Step 2: With the whole assembly upside down, drop the rear action screw with washer into the hole just behind the trigger guard, turn the screw to engage the threads in the action. Again do not fully tighten.

Step 2a: for CZ-457 ONLY (Front Action Screw)

Clearance cut on bushing
goes toward rear to clear
magazine well screw

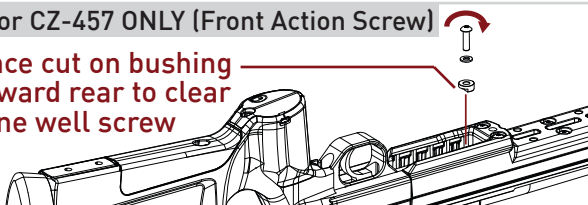

Insert the rear action screw

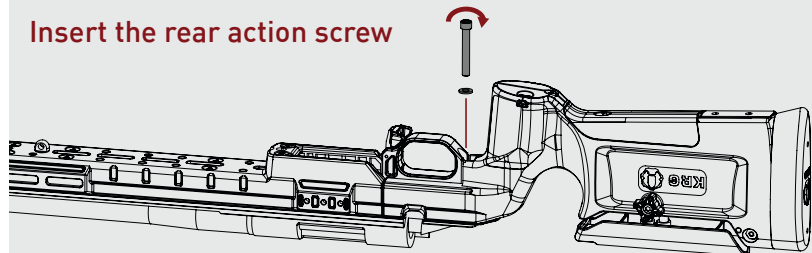

*** Front action screw
already captured

Step 3: Pull the action towards the rear of the stock while holding the stock stationary. This is to seat the action against the recoil lug. A good way is to set the rifle vertical on the butt pad and bounce it on the ground a couple times.

Step 5: Torque both screws to 65 in-lbs of torque in an incremental manner, moving back and forth between the two screws until full torque is reached. *****for CZ-457 ONLY apply 45 in-lbs of torque for both screws.**

Time to adjust the stock to fit you!

Step 1: Remove the buttpad using a 3mm metric hex/allen wrench.

Step 3: Install the buttpad back onto the buttpad stock with the spacers captured between them.

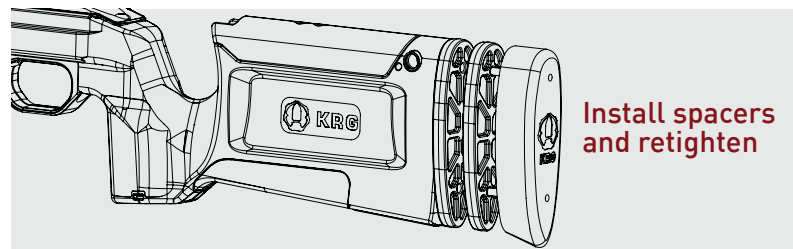
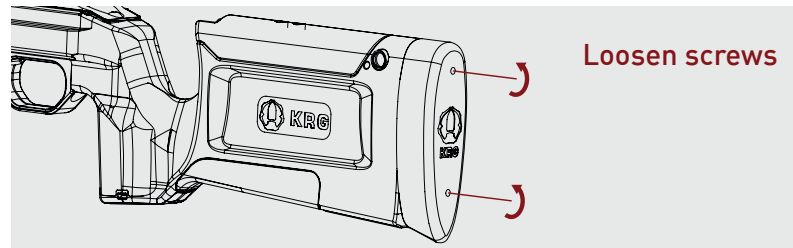

Step 1: Loosen the thumbscrew and move the cheekpiece to your desired position. Retighten the thumbscrew.

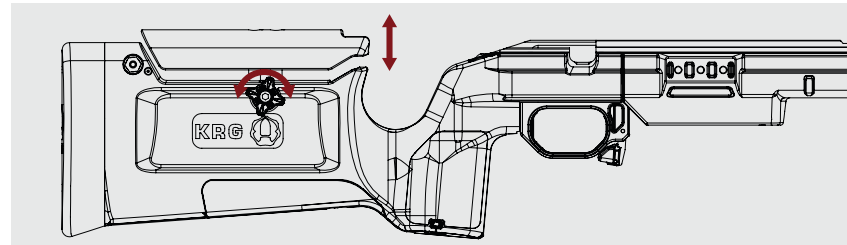

MOE L2 HOLE SPACING
BRAVO CHASSIS BAG RIDER SPACING

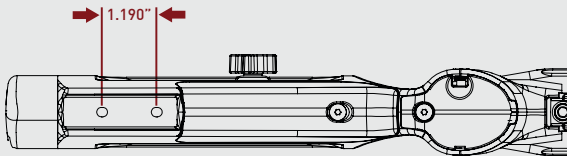

Rem 700 SA shown

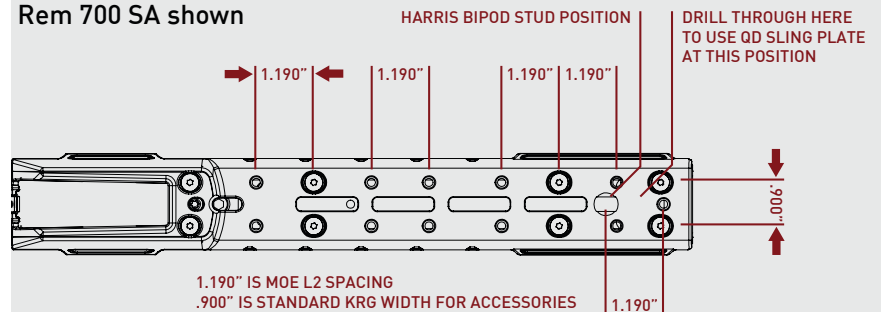

www.KRG-OPS.com